

# Ascend Gas Arm with top fix Clamp

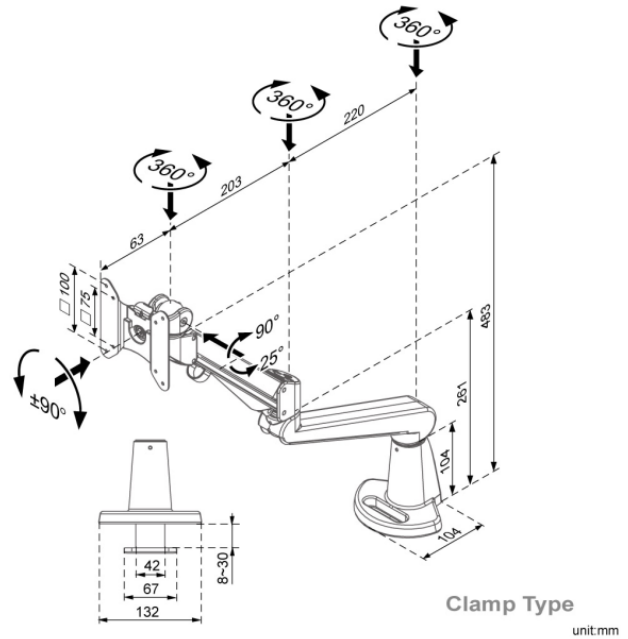

## Product Specification

Product code	CMS3035C-ED & CMS3163 – WHITE
*Weight capacity	From 3 - 8 kg
**Maximum Screen Size	36"
Height adjustment range	200mm – 500mm from desktop
Max forward extension	486mm
VESA	75mm & 100mm VESA compliant
Movement	Height adjustment, tilt, swivel, rotation and reach

\*Capacity may be reduced if monitor size is greater than 26" or depth is greater than 5.5cm  
\*\*Subject to weight being within range & VESA 75 x 75mm or 100 x 100mm, please refer to our measurements / line drawings and check with screen manufacturers measurements including bezel

## Additional Information

Clamp for desktops up to 8mm - 30mm
Integral cable management
Gas assisted height adjustment
Lockable quick release VESA function
180° anti rotation feature
Over 90% of the aluminium alloy content is recycled



**Ergo**  
01235 773373  
[www.ergoltd.co.uk](http://www.ergoltd.co.uk)  
[sales@ergoltd.co.uk](mailto:sales@ergoltd.co.uk)